

ALCHIP™-MVE 系列

- 表面安装
- 小型化
- 耐清洗
- RoHS指令适应品

- 额定电压 6.3V ~ 450V。
- 保证 105°C 1,000 ~ 2,000 小时。
- 产品尺寸: $\phi 4 \times 5.2L \sim \phi 18 \times 21.5L$ 。

MVE 长寿命化 → MVL MVJ



规格表

项目	性能											
工作温度范围	-40~+105°C											
额定电压范围	6.3~450V _{dc}											
静电容量容许差	±20%(M) (20°C、120Hz)											
漏电流	额定电压 (V _{dc})	6.3~100V									160~450V	
	D55~JA0	I ≤ 0.01CV 或者 3μA 中任意一个较大值 (2分值)									—	
	KE0~MNO	I ≤ 0.03CV 或者 4μA 中任意一个较大值 (1分值)									I ≤ 0.04CV+100μA (1分值)	
	I: 漏电流 (μA)、C: 静电容量 (μF)、额定电压 (V _{dc}) (20°C)											
损失角正切值 (tan δ)	≤ 标准品一览表中的值 (20°C、120Hz)											
温度特性 (阻抗比 右表值以下)	额定电压 (V _{dc})	6.3V	10V	16V	25V	35V	50V	63V	100V	160~250V	400~450V	
	D55~JA0	Z(-25°C) / Z(+20°C)	4	3	2	2	2	2	2	3	—	—
		Z(-40°C) / Z(+20°C)	12	8	6	4	3	3	3	4	—	—
	KE0~MNO	Z(-25°C) / Z(+20°C)	5	4	3	2	2	2	2	2	3	6
Z(-40°C) / Z(+20°C)		10	8	6	4	3	3	3	3	6	10	
耐久性	在105°C环境中, 按照规定时间连续加载额定电压后, 待温度恢复到20°C进行测量时, 应满足以下要求。											
	尺寸代码	D55~F80				HA0~MNO						
	规定时间	1,000小时				2,000小时						
	静电容量变化率	≤ 初始值的±30%				≤ 初始值的±20%						
	损失角正切值	≤ 初始规格值的300%				≤ 初始规格值的200%						
	漏电流	≤ 初始规格值				≤ 初始规格值						
高温无负荷特性	在105°C环境中, 无负荷放置1,000小时(D55~F80:500小时)后待温度恢复到20°C, 进行试验前处理(JIS C 5101-4 4.1项)后进行测量时, 应满足以下要求。											
	尺寸代码	D55~F80				HA0~MNO						
	静电容量变化率	≤ 初始值的±25%				≤ 初始值的±20%						
	损失角正切值	≤ 初始规格值的200%				≤ 初始规格值的200%						
	漏电流	≤ 初始规格值				≤ 初始规格值						

尺寸图 (CE32形) [mm]

● 端子代码: A

● 尺寸代码: D55~MNO

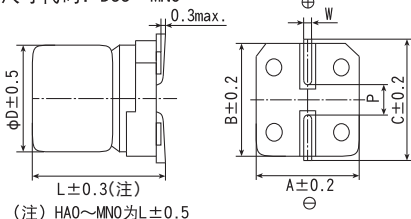

● 端子代码: G

● 尺寸代码: LHO~MNO (带辅助端子)

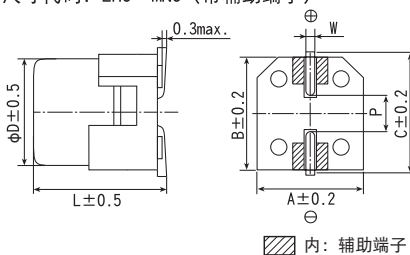

尺寸代码	D	L	A	B	C	W	P
D55	4	5.2	4.3	4.3	5.1	0.5~0.8	1.0
E55	5	5.2	5.3	5.3	5.9	0.5~0.8	1.4
F55	6.3	5.2	6.6	6.6	7.2	0.5~0.8	1.9
F80	6.3	7.7	6.6	6.6	7.2	0.5~0.8	1.9
HA0	8	10.0	8.3	8.3	9.0	0.7~1.1	3.1
JA0	10	10.0	10.3	10.3	11.0	0.7~1.1	4.5
KE0	12.5	13.5	13.0	13.0	13.7	1.0~1.3	4.2
KG5	12.5	16.0	13.0	13.0	13.7	1.0~1.3	4.2
LHO	16	16.5	17.0	17.0	18.0	1.0~1.3	6.5
LNO	16	21.5	17.0	17.0	18.0	1.0~1.3	6.5
MHO	18	16.5	19.0	19.0	20.0	1.0~1.3	6.5
MNO	18	21.5	19.0	19.0	20.0	1.0~1.3	6.5

产品型号体系

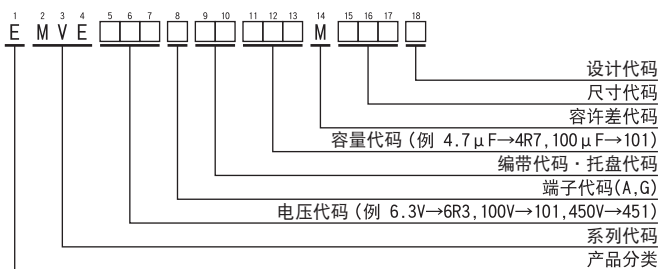

产品型号代码的详细介绍请参考「产品型号的表示方法(贴片型)」。

标示

标示例 (D55~JA0)
16V22μF



标示例 (KE0~MNO)
25V1,000μF



ALCHIP™-MVE 系列

◆标准品一览表

□ 内的产品(100~450Vdc)不能进行基板清洗。

WV (Vdc)	Cap (μF)	尺寸代码	tan δ	额定纹波电流 (mA _{rms} /105°C, 120Hz)	产品型号	WV (Vdc)	Cap (μF)	尺寸代码	tan δ	额定纹波电流 (mA _{rms} /105°C, 120Hz)	产品型号	
6.3	22	D55	0.30	22	EMVE6R3ADA220M55G	35	330	JA0	0.16	450	EMVE350ADA331MJA0G	
	33	E55	0.30	34	EMVE6R3ADA330ME55G		470	KE0	0.22	520	EMVE350ARA471MKE0S	
	47	E55	0.30	38	EMVE6R3ADA470ME55G		470	LH0	0.22	650	EMVE350□DA471MLH0S	
	100	F55	0.30	69	EMVE6R3ADA101MF55G		1,000	LH0	0.22	750	EMVE350□DA102MLH0S	
	220	F80	0.45	120	EMVE6R3ADA221MF80G		1,000	MH0	0.22	1,000	EMVE350□DA102MMH0S	
	330	HA0	0.40	290	EMVE6R3ADA331MHA0G		2,200	MN0	0.24	1,450	EMVE350□DA222MMN0S	
	470	HA0	0.45	320	EMVE6R3ADA471MHA0G	50	1.0	D55	0.12	8.0	EMVE500ADA1R0MD55G	
	680	HA0	0.45	340	EMVE6R3ADA681MHA0G		2.2	D55	0.12	12	EMVE500ADA2R2MD55G	
	1,000	JA0	0.40	410	EMVE6R3ADA102MJA0G		3.3	D55	0.12	15	EMVE500ADA3R3MD55G	
	1,500	JA0	0.45	550	EMVE6R3ADA152MJA0G		4.7	E55	0.12	20	EMVE500ADA4R7ME55G	
	2,200	KE0	0.40	680	EMVE6R3ARA222MKE0S		10	F55	0.12	32	EMVE500ADA100MF55G	
	2,200	LH0	0.40	840	EMVE6R3□DA222MLH0S		33	F80	0.14	65	EMVE500ADA330MF80G	
	3,300	KG5	0.42	850	EMVE6R3ARA332MKG5S		47	F80	0.14	80	EMVE500ADA470MF80G	
	3,300	MH0	0.42	1,000	EMVE6R3□DA332MMH0S		100	HA0	0.14	230	EMVE500ADA101MHA0G	
	4,700	LN0	0.44	1,200	EMVE6R3□DA472MLN0S		220	JA0	0.14	375	EMVE500ADA221MJA0G	
	4,700	MH0	0.44	1,200	EMVE6R3□DA472MMH0S		330	KE0	0.18	500	EMVE500ARA331MKE0S	
6,800	LN0	0.48	1,200	EMVE6R3□DA682MLN0S	330		LH0	0.18	600	EMVE500□DA331MLH0S		
6,800	MN0	0.48	1,350	EMVE6R3□DA682MMN0S	470		LH0	0.18	700	EMVE500□DA471MLH0S		
470	MH0	0.18	750	EMVE500□DA471MMH0S	470		MH0	0.18	750	EMVE500□DA471MMH0S		
1,000	MN0	0.18	1,200	EMVE500□DA102MMN0S	1,000		MN0	0.18	1,200	EMVE500□DA102MMN0S		
10	22	E55	0.24	30	EMVE100ADA220ME55G	63	1.0	D55	0.12	8.0	EMVE630ADA1R0MD55G	
	33	E55	0.24	34	EMVE100ADA330ME55G		2.2	D55	0.12	12	EMVE630ADA2R2MD55G	
	47	F55	0.24	48	EMVE100ADA470MF55G		3.3	E55	0.12	17	EMVE630ADA3R3ME55G	
	100	F55	0.30	69	EMVE100ADA101MF55G		4.7	F55	0.12	22	EMVE630ADA4R7MF55G	
	150	F80	0.35	100	EMVE100ADA151MF80G		10	F55	0.12	32	EMVE630ADA100MF55G	
	220	F80	0.35	120	EMVE100ADA221MF80G		22	F80	0.12	58	EMVE630ADA220MF80G	
	330	HA0	0.35	290	EMVE100ADA331MHA0G		33	HA0	0.12	140	EMVE630ADA330MHA0G	
	470	HA0	0.35	320	EMVE100ADA471MHA0G		47	HA0	0.12	170	EMVE630ADA470MHA0G	
	1,000	JA0	0.35	410	EMVE100ADA102MJA0G		100	JA0	0.12	310	EMVE630ADA101MJA0G	
	2,200	KG5	0.36	750	EMVE100ARA222MKG5S		220	KE0	0.14	470	EMVE630ARA221MKE0S	
	2,200	LH0	0.36	850	EMVE100□DA222MLH0S		220	LH0	0.14	560	EMVE630□DA221MLH0S	
	3,300	LH0	0.38	1,000	EMVE100□DA332MLH0S		330	LH0	0.14	700	EMVE630□DA331MLH0S	
	3,300	MH0	0.38	1,100	EMVE100□DA332MMH0S		330	MH0	0.14	750	EMVE630□DA331MMH0S	
	4,700	LN0	0.40	1,300	EMVE100□DA472MLN0S		470	LN0	0.14	900	EMVE630□DA471MLN0S	
4,700	MN0	0.40	1,350	EMVE100□DA472MMN0S	470	MH0	0.14	900	EMVE630□DA471MMH0S			
16	10	D55	0.20	17	EMVE160ADA100MD55G	100	22	HA0	0.12	100	EMVE101ADA220MHA0G	
	22	E55	0.20	30	EMVE160ADA220ME55G		33	JA0	0.12	150	EMVE101ADA330MJA0G	
	33	F55	0.20	45	EMVE160ADA330MF55G		47	KE0	0.10	250	EMVE101ARA470MKE0S	
	47	F55	0.20	48	EMVE160ADA470MF55G		68	KE0	0.10	300	EMVE101ARA680MKE0S	
	100	F55	0.26	69	EMVE160ADA101MF55G		100	KE0	0.10	380	EMVE101ARA101MKE0S	
	150	F80	0.28	100	EMVE160ADA151MF80G		100	LH0	0.10	450	EMVE101□DA101MLH0S	
	220	F80	0.28	120	EMVE160ADA221MF80G		220	LN0	0.10	750	EMVE101□DA221MLN0S	
	330	HA0	0.28	290	EMVE160ADA331MHA0G		220	MH0	0.10	750	EMVE101□DA221MMH0S	
	470	HA0	0.28	320	EMVE160ADA471MHA0G		330	MN0	0.10	980	EMVE101□DA331MMN0S	
	680	JA0	0.28	470	EMVE160ADA681MJA0G		160	33	KE0	0.15	95	EMVE161ARA330MKE0S
	1,000	KE0	0.30	550	EMVE160ARA102MKE0S			47	LH0	0.15	260	EMVE161□DA470MLH0S
	1,000	LH0	0.30	650	EMVE160□DA102MLH0S			68	LN0	0.15	320	EMVE161□DA680MLN0S
	2,200	LH0	0.32	950	EMVE160□DA222MLH0S			68	MH0	0.15	320	EMVE161□DA680MMH0S
	2,200	MH0	0.32	1,000	EMVE160□DA222MMH0S			100	LN0	0.15	380	EMVE161□DA101MLN0S
3,300	LN0	0.34	1,200	EMVE160□DA332MLN0S	200	10		KE0	0.15	80	EMVE201ARA100MKE0S	
3,300	MH0	0.34	1,200	EMVE160□DA332MMH0S		22	KG5	0.15	110	EMVE201ARA220MKG5S		
25	10	E55	0.16	27		EMVE250ADA100ME55G	33	LH0	0.15	220	EMVE201□DA330MLH0S	
	22	F55	0.16	44		EMVE250ADA220MF55G	47	LN0	0.15	270	EMVE201□DA470MLN0S	
	33	F55	0.16	50		EMVE250ADA330MF55G	47	MH0	0.15	270	EMVE201□DA470MMH0S	
	47	F55	0.16	60		EMVE250ADA470MF55G	68	MN0	0.15	330	EMVE201□DA680MMN0S	
	100	F80	0.18	100		EMVE250ADA101MF80G	250	4.7	KE0	0.15	65	EMVE251ARA4R7MKE0S
	150	HA0	0.18	240		EMVE250ADA151MHA0G		10	KG5	0.15	105	EMVE251ARA100MKG5S
	220	HA0	0.18	320		EMVE250ADA221MHA0G		22	LH0	0.15	180	EMVE251□DA220MLH0S
	330	JA0	0.16	450		EMVE250ADA331MJA0G		33	LN0	0.15	230	EMVE251□DA330MLN0S
	470	JA0	0.18	490		EMVE250ADA471MJA0G		33	MH0	0.15	230	EMVE251□DA330MMH0S
	1,000	LH0	0.26	820		EMVE250□DA102MLH0S		47	MN0	0.15	280	EMVE251□DA470MMN0S
	1,000	MH0	0.26	880		EMVE250□DA102MMH0S	400	4.7	KG5	0.20	50	EMVE401ARA4R7MKG5S
	2,200	LN0	0.28	1,250		EMVE250□DA222MLN0S		10	LH0	0.20	85	EMVE401□DA100MLH0S
	2,200	MN0	0.28	1,300	EMVE250□DA222MMN0S	22		MN0	0.20	130	EMVE401□DA220MMN0S	
	35	4.7	D55	0.14	16	EMVE350ADA4R7MD55G		450	3.3	KE0	0.20	40
10		E55	0.14	27	EMVE350ADA100ME55G	4.7			KG5	0.20	50	EMVE451ARA4R7MKG5S
22		F55	0.14	44	EMVE350ADA220MF55G	10			LH0	0.20	85	EMVE451□DA100MLH0S
47		F80	0.16	80	EMVE350ADA470MF80G	22	MN0		0.20	130	EMVE451□DA220MMN0S	
100		F80	0.16	100	EMVE350ADA101MF80G	450	3.3		KE0	0.20	40	EMVE451ARA3R3MKE0S
150		HA0	0.16	260	EMVE350ADA151MHA0G		4.7		KG5	0.20	50	EMVE451ARA4R7MKG5S
220	JA0	0.16	375	EMVE350ADA221MJA0G	10	LH0	0.20	85	EMVE451□DA100MLH0S			
					22	MN0	0.20	130	EMVE451□DA220MMN0S			

(注) □内为端子代码。